

Ei™ to Goldline Adaptor Fitting

Installation Instructions

⚠ WARNING

FOR YOUR SAFETY - For anything other than the routine cleaning and maintenance described in this manual, this product must be serviced by a contractor who is licensed and qualified in pool equipment by the jurisdiction in which the product will be installed where such state or local requirements exists. In the event no such state or local requirement exists, the installer or maintainer must be a professional with sufficient experience in pool equipment installation and maintenance so that all of the instructions in this manual can be followed exactly. Before installing this product, read and follow all warning notices and instructions that accompany this product. Failure to follow warning notices and instructions may result in property damage, personal injury, or death. Improper installation and/or operation will void the warranty.

Improper installation and/or operation can create unwanted electrical hazard which can cause serious injury, property damage, or death.

These instructions are to be used with the following Jandy® product:

R0519800 -- Ei to Goldline Adapter Fitting

1. Introduction

This document gives instructions and guidelines for installing the Ei to Goldline Adapter Fitting. The Ei to Goldline Adapter Fitting will allow you to replace your Goldline chlorine cell. with the Jandy AquaPure® Ei Chlorine Generating Device.

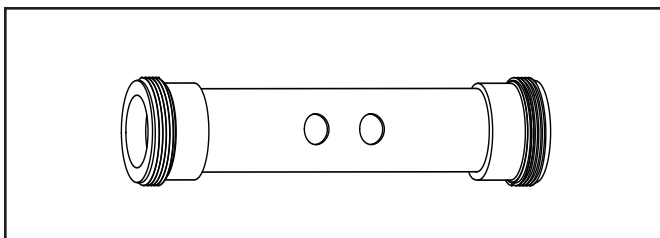

Figure 1. Ei to Goldline Adapter Fitting

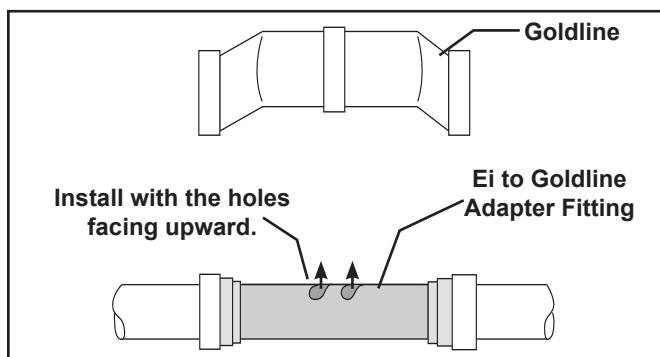

Figure 2. Ei to Goldline Adapter Installation

2. Installation Instructions

⚠ WARNING

EQUIPMENT UNDER PRESSURE: Always turn pump off prior to installing the Ei to Goldline Adaptor Fitting. Your pump/filter system is operated under pressure and the pressure must be released before you begin work. Please see your pump/filter owner's manual for further instructions.

Disconnect power to the system at the main circuit breaker before performing this procedure to avoid risk of electric shock which can result in property damage, severe injury or death.

1. Remove the Goldline chlorine cell.
2. In place of the Goldline chlorine cell., install the Ei to Goldline Adapter Fitting (see Figure 2).
3. Install the AquaPure Ei system according to the instructions supplied with the product. The adapter is pre-drilled to accept the AquaPure Ei system.

* The Goldline brand is property of Hayward Industries, Inc. and/or their families.



H0342200 Rev -



Zodiac Pool Systems, Inc.
6000 Condor Drive, Moorpark, CA, USA 93021 • 800.822.7933 FAX 877.327.1403
© 2010 Zodiac Pool Systems, Inc. All rights reserved. 1003