

Jandy® AquaPure® Ei™ Series Replacement Kits

for Models APURE35/35C, APURE35PLG/35PLGC

WARNING

FOR YOUR SAFETY - For anything other than the routine cleaning and maintenance described in this manual, this product must be serviced by a contractor who is licensed and qualified in pool equipment by the jurisdiction in which the product will be installed where such state or local requirements exists. In the event no such state or local requirement exists, the installer or maintainer must be a professional with sufficient experience in pool equipment installation and maintenance so that all of the instructions in this manual can be followed exactly. Before installing this product, read and follow all warning notices and instructions that accompany this product. Failure to follow warning notices and instructions may result in property damage, personal injury, or death. Improper installation and/or operation will void the warranty.

Improper installation and/or operation can create unwanted electrical hazard which can cause serious injury, property damage, or death.

These instructions are to be used with the following Jandy Replacement Parts:

- R0511300 -- R-Kit, Locking Ring**
- R0511600 -- R-Kit, O-Ring, Electrode Housing**
- R0511700 -- R-Kit, Saddle Clamp Assembly**
- R0512700 -- R-Kit, Winterizing Cap**

1. Introduction

This document gives instructions for replacing various components on the Jandy AquaPure Ei chlorine generating device.

The instructions were written with safety as the priority and must be followed exactly. Not following the written procedure or taking shortcuts may increase the risk of personal injury. Read through the instructions completely before starting the procedure.

Before starting the procedure, use the parts list at the back of these instructions to identify the parts that are in your kit. If any parts are missing from the kit please call your local Jandy distributor for assistance. For technical assistance, please contact our Technical Support Department at 1.800.822.7933.

2. Ordering Information

To order or purchase parts for the Jandy AquaPure Ei chlorine generating device, contact your nearest Jandy dealer or distributor. If they cannot supply you with what you need, call Zodiac Pool Systems, Inc. at 1.800.822.7933. In Canada call Zodiac Pool Systems Canada, Inc. Customer Support Department at 1.888.647.4004.

3. Installing R-Kits on Cells

⚠ WARNING

Disconnect power to the system at the main circuit breaker before performing this procedure to avoid risk of electric shock which can result in property damage, severe injury or death.

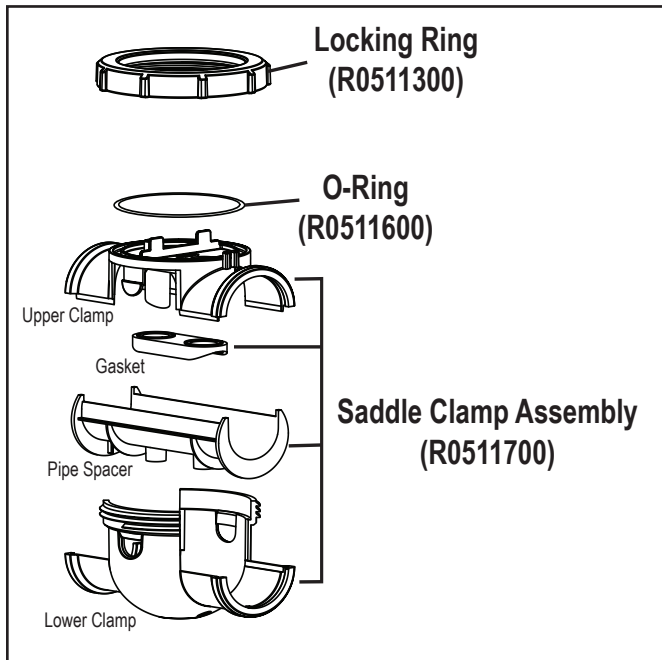

Figure 1. Exploded Cell Diagram

A. Replacing Locking Ring, O-Ring, and Saddle Clamp Assembly (ELECTRODE ONLY)

Disassemble to the component that needs replacement. After the part has been replaced, skip to Section B: Reassembling the electrode.

1. Ensure that all power to the power pack and the controller is disconnected/turned off at the circuit breaker. For model APURE35PLG/35PLGC, unplug the power pack from the power source.
2. Shut off any necessary valves to prevent any water loss.
3. Remove the terminal cap and cell leads.

4. Remove the locking ring. If necessary use the locking ring tool (R0512600) (see Figure 2).

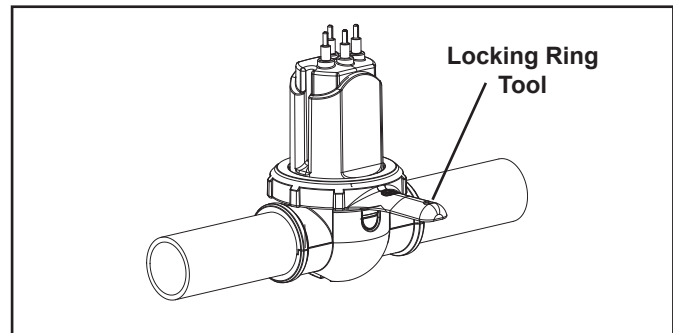

Figure 2. Undo Locking Ring

5. Remove the electrode (see Figure 3).

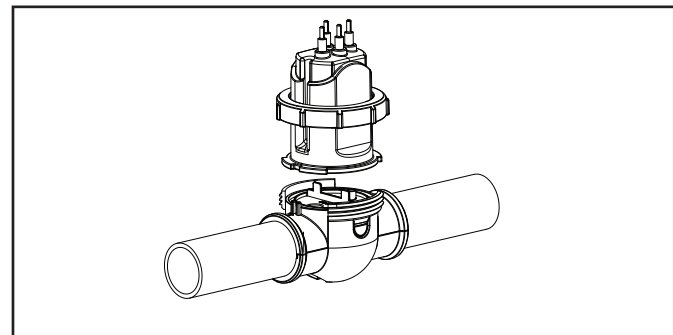

Figure 3. Remove Cell

6. Remove the o-ring.

NOTE If needed, extra o-rings can be ordered (O-Ring R-Kit - R0511600).

7. Press the two (2) push-buttons on either side of the upper clamp to separate the upper clamp from the lower clamp (see Figure 4).

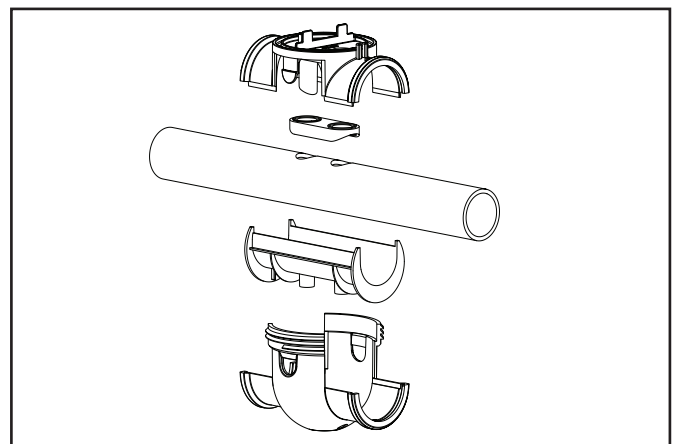

Figure 4. Removing Saddle Clamp from Pipe

8. Remove the upper clamp and gasket, the pipe spacer (if installed), and the lower clamp from the pipe.

B. Re-Assembling the Electrode

1. The replacement saddle clamp assembly will be clamped together. To install the clamp, first separate the upper and lower clamps by pressing the two (2) push-buttons on either side of the upper clamp.
2. Next, verify the gasket is attached to the upper clamp. The curved side of the gasket must be pointing down so that it will create a seal with the pipe.
3. Secure the clamps, pipe spacer (if necessary), and gasket around the pipe (see Figure 5) making sure the flow arrows on the clamp point in the direction of the water flow (see Figure 6). Make sure the two (2) clips on the sides of the clamp are snapped into place.

NOTE Use the pipe spacer if mounting on a 1½ in. (40mm) pipe.

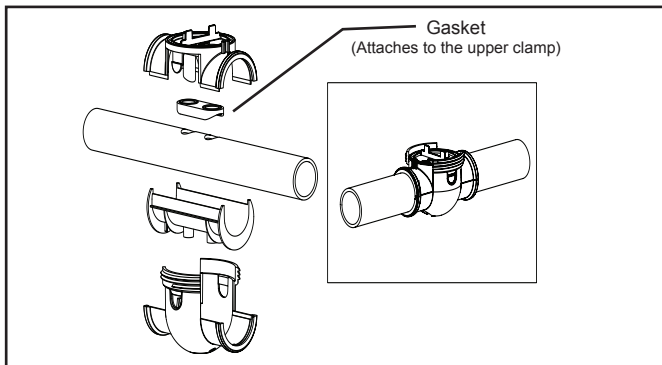

Figure 5. Attaching the Saddle Clamp

4. Verify the o-ring is inserted into the channel on the clamp (see Figure 6). Install the electrode.

NOTE A replacement o-ring is supplied with the Saddle Clamp R-Kit (R0511700). If needed, extra o-rings can be ordered (ref. O-Ring R-Kit - R0511600).

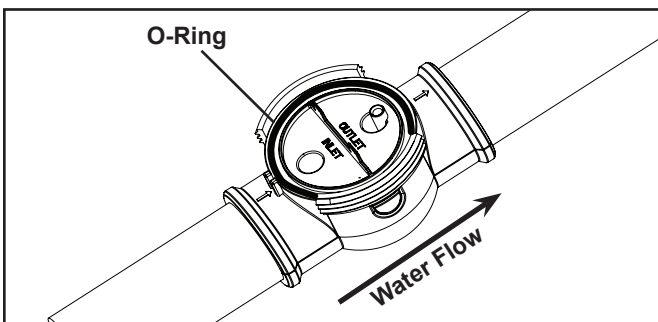

Figure 6. Water Flow Arrows

5. Position the locking ring in proper alignment, making sure the bump aligns with the top thread (see Figure 7).

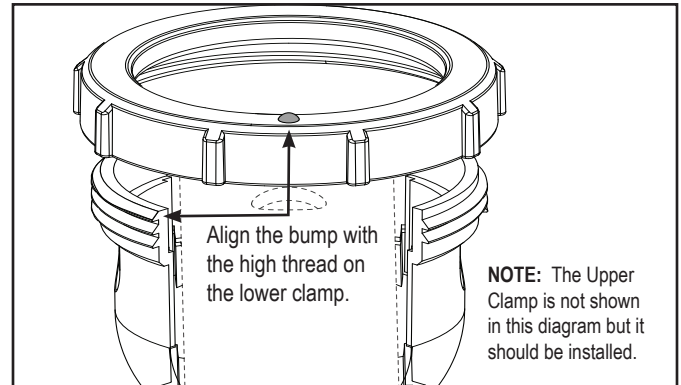

Figure 7. Locking Ring Alignment

6. Screw down the locking ring to the threaded clamp using the locking ring tool (see Figure 2).

NOTE Ensure the locking ring is level when engaging the threading clamp (see Figure 8).

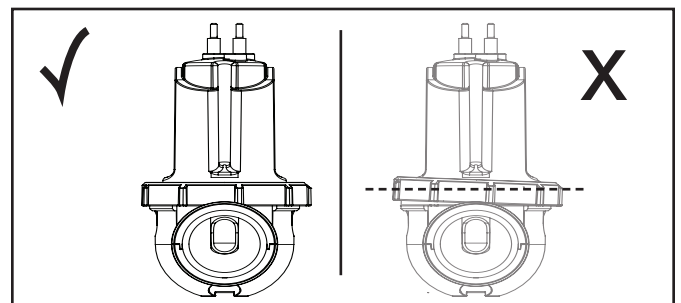

Figure 8. Locking Ring Level

7. Securely connect the cell leads to the like colored terminals (see Figure 9).

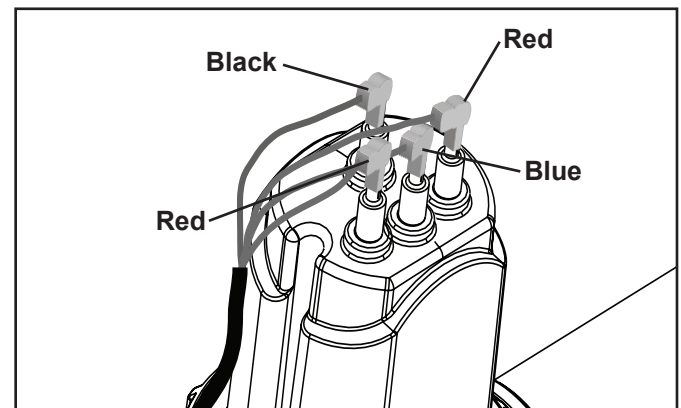

Figure 9. Connecting Cell Leads

8. Attach the terminal cap.
9. Reconnect the power.

4. Installing R-Kits on Pods

WARNING

Disconnect power to the system by unplugging the power pack before performing this procedure to avoid risk of electric shock which can result in property damage, severe injury or death.

A. Replacing the Saddle Clamp Assembly (POD ONLY)

1. Ensure that all power to the power pack and the controller is disconnected by unplugging the power pack from the power source.
2. Shut off any necessary valves to prevent any water loss.
3. Unplug the flow switch cable from the power pack.
4. Remove the locking ring. If necessary, use the locking ring tool (R0512600) (see Figure 2).
5. Remove the the pod housing.
6. Press the two (2) push-buttons on either side of the upper clamp to separate the upper clamp from the lower clamp (see Figure 10).

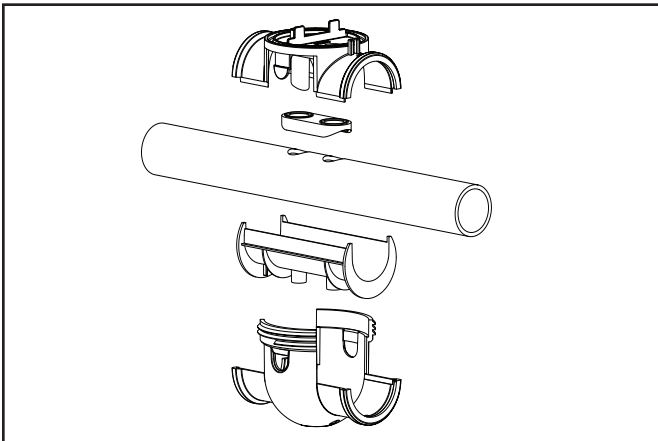

Figure 10. Removing Saddle Clamp from Pipe

7. Remove the upper clamp and gasket, the pipe spacer (if installed), and the lower clamp from the pipe.
8. The replacement clamp assembly will be clamped together. To install the clamp, first separate the upper and lower clamps by pressing the two (2) push-buttons on either side of the upper clamp.
9. Next, verify the gasket is attached to the upper clamp. The curved side of the gasket must be pointing down so that it will create a seal with the pipe.

10. Secure the clamps, pipe spacer, and gasket around the pipe making sure the flow arrows on the clamp point in the direction of the water flow. Make sure the two (2) clips on the sides of the clamp are snapped into place (see Figure 11).

NOTE Use the pipe spacer if mounting on a 1½ in. (40mm) pipe.

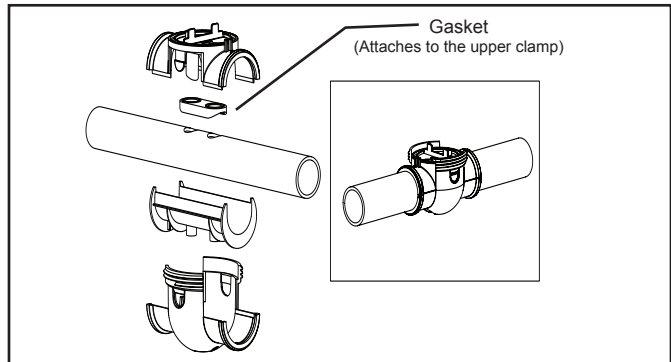

Figure 11. Attaching the Saddle Clamp

11. Install the pod housing as shown. Make sure the flow switch is in line with the pipe (see Figure 12 and 13).

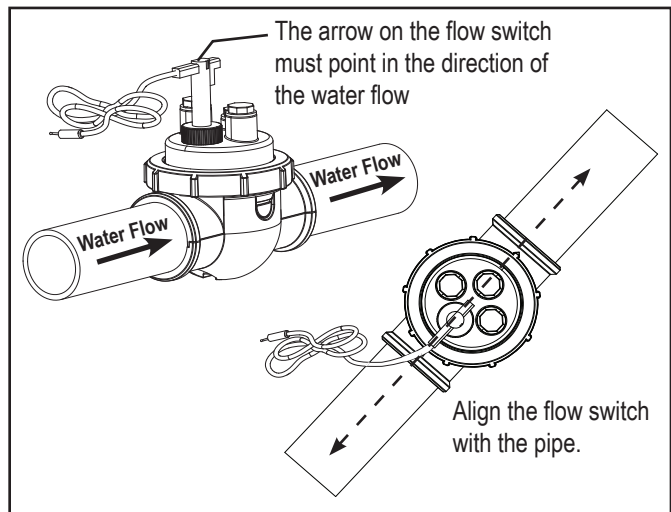

Figure 12. Replacing the Flow Switch

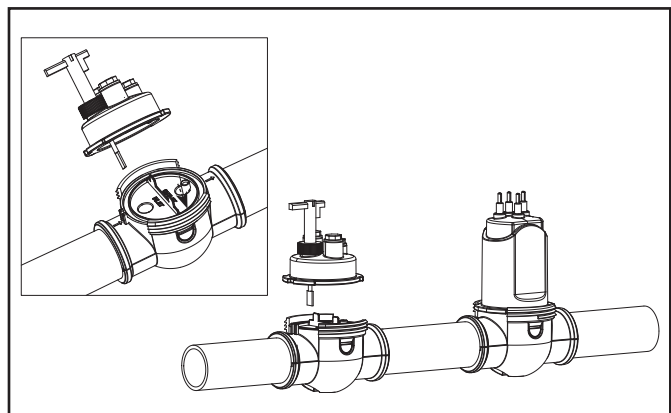

Figure 13. Installing Pod

- Position the locking ring in proper alignment, making sure the bump aligns with the top thread (see Figure 14).

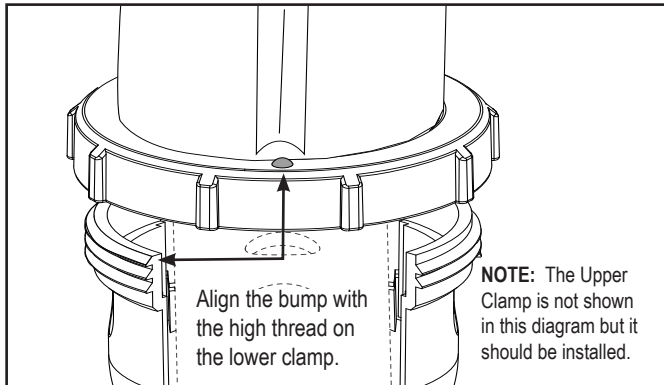

Figure 14. Locking Ring Alignment

- Screw down the locking ring to the threaded clamp using the locking ring tool (see Figure 15).

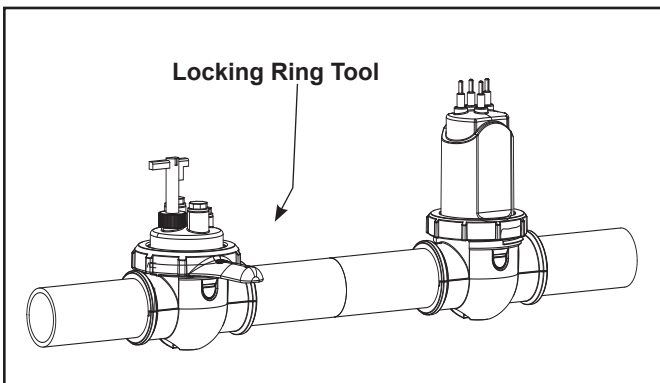

Figure 15. Locking Ring Tool

NOTE Ensure the locking ring is level when engaging the threading clamp (see Figure 16).

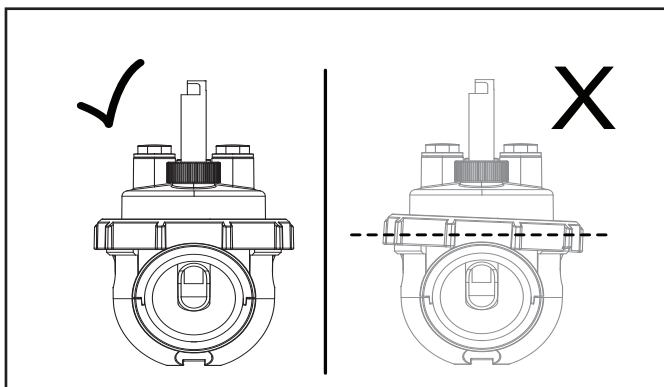

Figure 16. Locking Ring Level

- Plug the flow switch cable into the power pack.
- Reconnect the power.

5. Installing the Winterizing Cap

- Remove the cell (see Section 3.A). If applicable, remove the pod (see Section 4.A).
- Attach the winterizing cap (see Figure 17).
- Position the locking ring in proper alignment, before threading.
- Screw down the locking ring to the threaded clamp using the locking ring tool.

NOTE Ensure the locking ring is level when engaging the threading housing (see Figure 17).

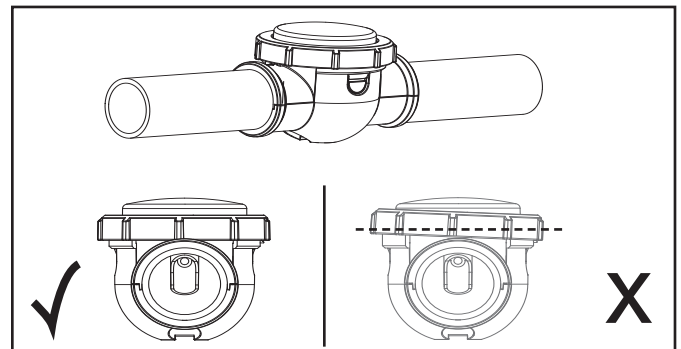

Figure 17. Winterizing Cap Installed

6. Parts List

The following table is for your reference. To order additional parts, please contact your local Jandy Distributor.

| | R0511300 | R0511600 | R0511700 | R0512700 |
|--------------------|----------|----------|----------|----------|
| Description | | | | |
| Locking Ring | 1 | -- | -- | -- |
| O-Ring | 1 | 1 | 1 | 1 |
| Upper Clamp | -- | -- | 1 | -- |
| Gasket | -- | -- | 1 | -- |
| Pipe Spacer | -- | -- | 1 | -- |
| Lower Clamp | -- | -- | 1 | -- |
| Winterizing Cap | -- | -- | -- | 1 |

H0344100 Rev-



ZODIAC POOL SYSTEMS, INC.

2620 Commerce Way • Vista, CA • 92081
Tel: 800-822-7933 • Fax: 877-327-1403



ETL Listed
Conforms To
UL STD 1081
Certified to
CAN/CSA C22.2 NO. 218.1

For warranty support in Canada:
Zodiac Pool Systems Canada, Inc.
2115 South Service Road West, Unit 3
Oakville, Ontario • Canada L6L 5W2
Tel: 888-647-4004 • Fax: 905-825-5780